



The Royal Australasian
College of Physicians



Australasian Faculty of
Occupational and Environmental Medicine

AFOEM

ANNUAL TRAINING MEETING 2016

FRIDAY, 13 MAY to SUNDAY, 15 MAY 2016

HANDBOOK

CONTENTS

Contributors	1
Welcome message	2
Program	3
Sponsors	3
About training in occupational and environmental medicine	4
Locations and venues	5
Worksite locations Group A	6
Worksite locations Group B	7
Worksite locations Group C	8
Worksite locations Group D	9
Floor plans Glenside Campus	10
Floor plans Adelaide Convention Centre	11
General information	12
The ANZSOM prize	13
Speakers	14
Abstracts.....	21
References and pre-session readings	22
Notes	23

CONTRIBUTORS

AFOEM ATM Working Group
Dr Ilse-Marie Stockhoff, FAFOEM, Chair
Dr Benson Pek, AFOEM
Dr Zen Lee Yap, AFOEM
Dr John L. Wilson, FAFOEM
Ms Dominique Holt – Manager, Faculties, RACP
Ms Annette Barker – Interim Executive Officer, AFOEM
Ms Rumbidzai Zhou – Executive Officer, AFOEM
Ms Anne Chang – Events Administrator, RACP Events

DISCLAIMER

Every effort has been made to present all the information contained in this document as accurately as possible. The ATM Working Group takes no responsibility for changes to the program or any loss and/or damage that may occur as a result of changes to the program.

Some of the information contained in this publication has been provided by external sources. Although every effort has been made to ensure the accuracy, currency and reliability of the content, the organisers accept no responsibility in that regard.

WELCOME MESSAGE

Dear Australasian Faculty of Occupational and Environmental Medicine trainees,

Welcome to the 2016 Annual Training Meeting (ATM) and to Adelaide.

This year's meeting promises to provide you with key learning outcomes that will not only assist with your training, but give you knowledge and insights that you will use into the future.

The ATM Working Group has developed an interesting program of workplace visits, along with a wide range of educational topics covering most subjects included in the Australasian Faculty of Occupational and Environmental Medicine (AFOEM) examinations and assessments, for all training levels.

I am looking forward to a lively talk by our Faculty President, Dr David Beaumont and President-Elect, Dr Peter Connaughton who will both join us on the third day of the ATM to discuss the current status of the Faculty and its future direction.

The ATM is also your opportunity to express your views and ask questions of the ATM Working Group and other representatives of the AFOEM Education, Training and Assessment Committees. The Faculty welcomes feedback about your training experience and the ATM is the perfect place to share your thoughts in an informal setting.

A highlight of the meeting is the AFOEM ATM Dinner on Saturday evening. This year we will be dining at the Durrell Gallery Adelaide Zoo, and I look forward to seeing you there.

I hope you get as much out of the ATM as I did during my training. It is always good to share learning with peers and colleagues and the collegiate environment of the ATM makes it an educational and enjoyable experience. I'm looking forward to a lively meeting.

Dr Ilse-Marie Stockhoff
AFOEM ATM Working Group Chair



PROGRAM

The Australasian Faculty of Occupational and Environmental Medicine Annual Training Meeting is the only national annual training event, which gives you, the trainee, an opportunity to attend worksite visits and complete your direct observation of field skills.

For an overview of the Annual Training Meeting view the program [here](#).

SPONSORS

AFOEM ATM Dinner Sponsor



Exhibition Partner



About Training in the Occupational and Environmental Medicine Program

Training in Occupational and Environmental Medicine (OEM) under the Physician Readiness for Expert Practice (PREP) framework develops the knowledge, skills and behaviours that a specialist Occupational and Environmental Physician (OEP) is required to have in order to practice OEM effectively.

OEM training is a vocational, on-the-job educational program, underpinned by nine key competencies that reflect the clinical, preventive and population-based aspects of OEM and guide the aims, objectives and individual components of the program. The competencies are represented in the training program under the following domain names:

- Clinical practice
- Workplace hazard assessment
- Critical appraisal of information
- Research methods
- Working with leaders
- Professional qualities
- Law and medicine
- Fitness and return to work
- Environmental risks and incidents

Domains are divided into sub-domains, themes and specific learning objectives, the latter numbering 172 in total, with some appearing in more than one stage of the curriculum.

Unlike other RACP training programs which are predominantly hospital-based, OEM training does not involve a series of registrar-level rotations at accredited training sites and is instead nearly always conducted in community settings.

Trainees are supported by a regional Training Program Director and receive guidance from Fellows who have agreed to be their educational supervisor.

OEM training is based around three stages – Stage A is a ‘basic’ stage and Stages B and C are advanced stages.

- Stage A (12 months) emphasises clinical skills, critical appraisal skills and professional qualities.
- Stage B (24 months) includes all the special features that distinguish OEM – fitness and return to work, interacting with organisations, relevant law, and assessment of work-related hazards and environmental risks and incidents.
- Stage C (6 months) addresses the abilities that distinguish an OEP including high-level communication, policy development, funding and staffing a service, and completion of research.

Assessments mark the end of each stage of learning, however there are ‘formative’ assessments to be completed during the stages.

There is no designated minimum period of training in Occupational and Environmental Medicine, but a typical period is four to five years. The periods in brackets (above) represent the likely minimum times spent at each stage, although it is possible to bypass Stage A by meeting specific eligibility requirements.

Trainees have a maximum of 10 years in which to complete all components of the training and assessment and are responsible for their own progress through the competency based program.

[Training Portals](#)
[Training Support Pathway](#)
[Resources – Occupational and Environmental Resources](#)

LOCATIONS AND VENUES

Date and Times	Event/Function	Location
Friday, 13 May 2016 7.30am - 8.30am	Worksite visits – registration and welcome	RACP Adelaide Office Suite 7, Level 2, 257 Melbourne Street NORTH ADELAIDE SA 5006
Friday, 13 May 2016 9.30am - 4pm	Worksite visits – morning and afternoon sessions	Worksite visits at various locations, refer to worksite locations
Saturday, 14 May 2016 7.45am - 8.15am	Clinical day – registration and welcome	Glenside Health Service (Glenside Campus) 226 Fullarton Road, GLENSIDE SA 5065
Saturday, 14 May 2016 8.15am - 5pm	Clinical day – sessions	Glenside Health Service (Glenside Campus) 226 Fullarton Road, GLENSIDE SA 5065
Saturday, 14 May 2016 6.30pm	ATM dinner – bus departing for dinner venue	Adelaide Convention Centre North Terrace ADELAIDE SA 5000
Saturday, 14 May 2016 7pm for 7.30pm - 9.30pm	ATM dinner	Sanctuary Adelaide Zoo Frome Road ADELAIDE SA 5000
Sunday, 15 May 2016 8am - 8.30am	ATM day three – registration and welcome	Adelaide Convention Centre North Terrace ADELAIDE SA 5000
Sunday, 15 May 2016 8.30am - 3.30pm	ATM day three – sessions	Adelaide Convention Centre North Terrace ADELAIDE SA 5000

WORKSITE LOCATIONS - REGISTRATION

Worksite visits – registration

7.30am - 8.30am

RACP Adelaide

Suite 7, Level 2, 257 Melbourne Street

NORTH ADELAIDE SA 5006

[Click to view map](#)



WORKSITE LOCATIONS - GROUP A

Group A – morning session

9.30am - 12pm

Royal Australian Air Force Institute of Aviation
Medicine

Building 103, RAAF Base Edinburgh,

Third Avenue

EDINBURGH SA

[Click to view map](#)



Group A – afternoon session

1.30pm - 4pm

Visy Board

24-26 White Road

GEPPS CROSS SA

[Click to view map](#)



WORKSITE LOCATIONS - GROUP B

Group B – morning session

9.30am - 12pm

Holden

Phillip Highway

ELIZABETH SA

[Click to view map](#)



Group B – afternoon session

1.30pm - 4pm

Orora Glass

48 Argent Road

KINGSFORD SA

[Click to view map](#)



WORKSITE LOCATIONS - GROUP C

Group C – morning session

9.30am - 12pm

ASC

640 Mersey Road

OSBORNE SA

[Click to view map](#)



Group C – afternoon session

1.30pm - 4pm

National Railway Museum

Lipson Street (Adjacent to Godfrey Street)

PORT ADELAIDE SA

[Click to view map](#)



WORKSITE LOCATIONS - GROUP D

Group D – morning session

9.30am - 12pm

Pacific National Adelaide Freight Terminal

Pedder Crescent

REGENCY PARK SA

[Click to view map](#)



Group D – afternoon session

1.30pm - 4pm

Coca Cola Amatil

33-43 Port Road

THEBARTON SA

[Click to view map](#)



FLOOR PLANS GLENSIDE CAMPUS

Glenside Health Service

Meeting rooms are located within the Administration and Learning Services Centre

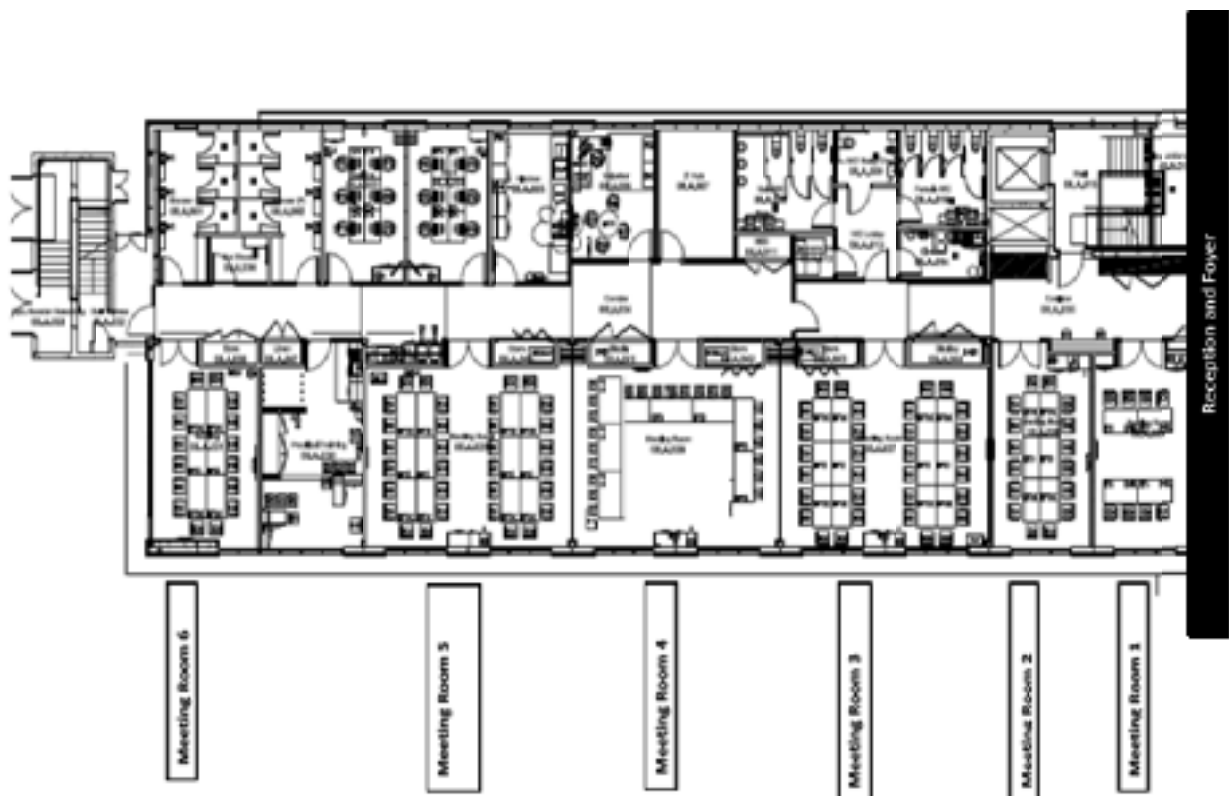
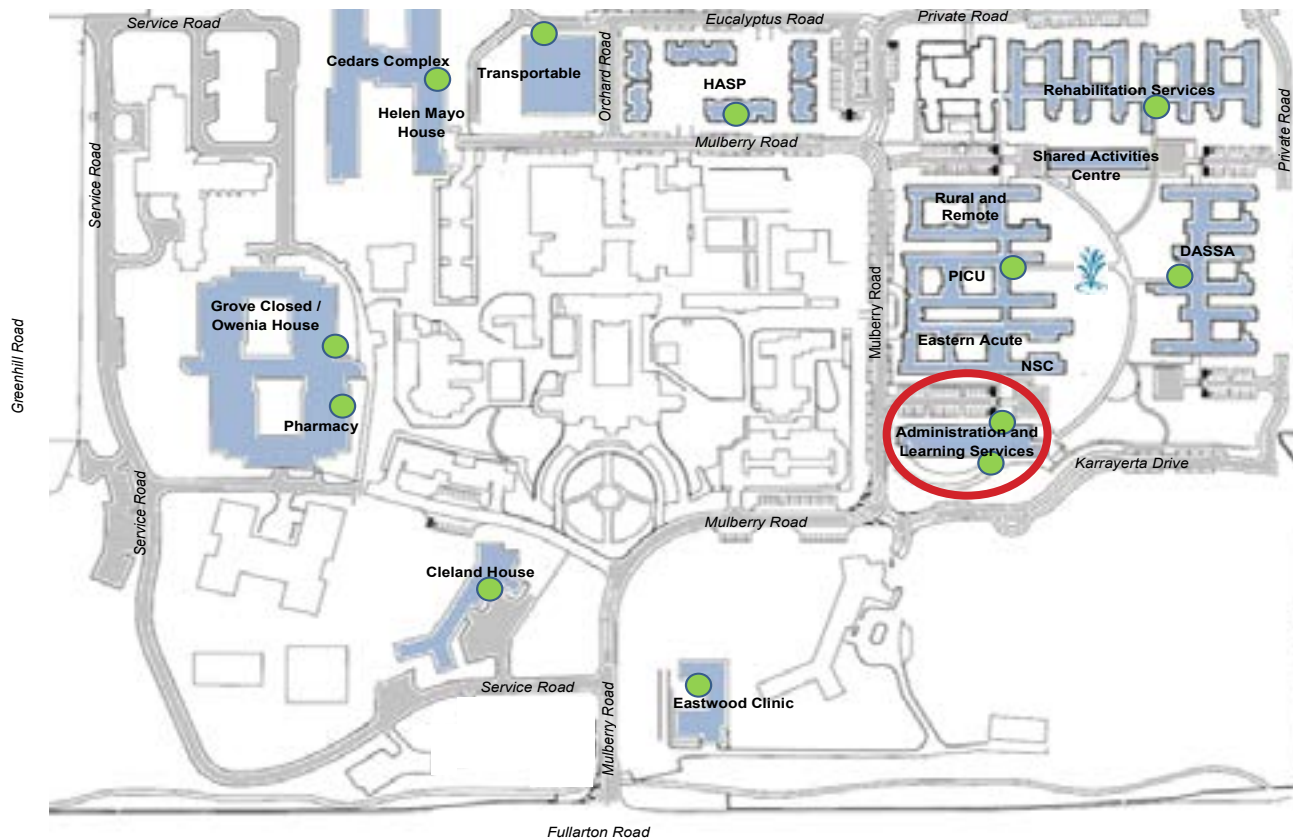

FLOOR PLAN ADELAIDE CONVENTION CENTRE

City rooms C3 and C4 - upper level

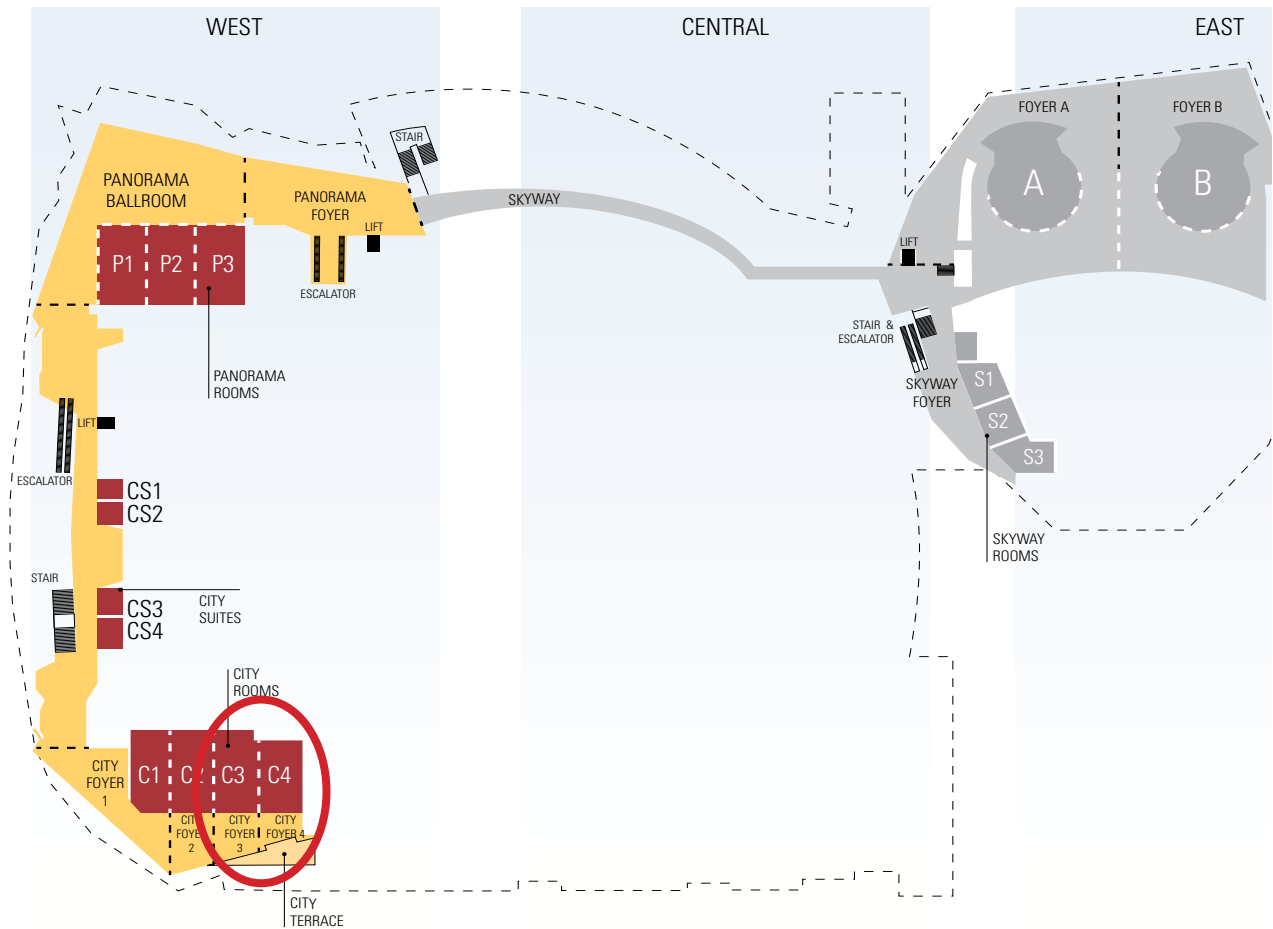

GENERAL INFORMATION

Glenside Health Services

Internet access

No Wi-Fi service is available at Glenside Health Services.

ATM facilities

No ATM facilities available at Glenside Health Services.

Parking

Free onsite parking is available at Glenside Health Services.

Adelaide Convention Centre

Internet access

Complimentary Wi-Fi is offered by the Adelaide Convention Centre. Please select the network 'ACC Free' on your device. No password is required. This service is capped at 75 MB per day and is designed for web browsing and checking web based emails.

ATM facilities

ATMs are located within the Adelaide Convention Centre in the foyers of both the West Entrance and East Entrance.

Business Centre

There is no Business Centre located within the Adelaide Convention Centre. We recommend you use the business services at your hotel if required.

Parking

The Adelaide Convention Centre offers two undercover car parking options, the North Terrace and the Riverbank Car Parks.

The North Terrace parking is recommended for assessable parking as the allocated spaces are close to both the exit and the lifts.

Certificate of attendance

An electronic certificate of attendance will be emailed to all delegates after the ATM.

THE ANZSOM PRIZE

All AFOEM trainees who register for the 2016 AFOEM Annual Training Meeting (ATM) are eligible to enter the ANZSOM Essay Prize.

The prize of \$1000 has been funded by the South Australian Branch of the Australian and New Zealand Society of Occupational Medicine (ANZSOM) and will be awarded to the best essay on the following topic:

Bias, partisanship and conflict of interest, in medico-legal reporting.

The essay should be approximately 2500 words.

The judges will take the following into consideration:

- grammar, spelling, and the general layout of the essay, including headings
- how the subject is presented, and any conclusions that can be drawn
- originality in dealing with the topic, and research methodology

Trainees can obtain material for this essay from the following resources:

- presenters at the ATM on medico-legal topics
- interaction with Fellows at the ATM
- a presentation on the subject of bias by Dr Carolyn Semmler in the AFOEM stream at Congress
- the ANZSOM most recent e-newsletter published on its website in April 2016. (This is available to members only, however it is anticipated that trainees who are not ANZSOM members will source a download from an existing member)
- internet searches

Entrants must register with the Faculty office. An identifier number will then be issued, to be displayed on the front page of the essay. No other identification is required.

Entries must be submitted to the Faculty office as a Word document by 20 July 2016.

The judging panel is made up of ANZSOM members in South Australia who will present a short list of six entrants to AFOEM. The winning entry will be decided by the Chair of the Education Committee.

It is expected that the winner will be notified by the end of August.

Good luck

Dr John Wilson
ANZSOM Branch Chairman SA

SPEAKERS



Ms Natalie Bottroff

Natalie Bottroff, using her qualifications and experience in injury management, rehabilitation and training delivery, workplace training and mental health first aid training, is a hands-on practitioner, presenter and trainer, and co-author of *On The Front Foot*.

Her experience and creativity have seen her develop and implement new and exciting return to work practices and unique education programs that are recognised and awarded by Self Insurers of South Australia and ReturnToWorkSA.

She leads a team of experienced consultants in her own practice, bringing the same enthusiasm, passion and commitment to improving injury management practices as when she started out over two decades ago.



Dr Beata Byok

Beata (Beatrice) Byok, is an Occupational and Environmental Physician and a graduate of the University of Adelaide Medical School. She has worked in occupational health for 30 years in a wide range of settings from the uranium/copper mine and processing plant at Olympic Dam, fly-in fly-out, Mitsubishi Motors and Holden, to the public service sector.

Currently she is in private practice and is also a contracted medical consultant to ReturnToWorkSA.

She is a past chair of the South Australian Australasian Faculty of Occupational and Environmental Medicine (AFOEM) and The Australian and New Zealand Society of Occupational Medicine (ANZSOM) committees and is the current AFOEM State Councillor and clinical examiner for the Faculty.



Dr David Beaumont

David Beaumont is the Medical Director and CEO of Fit For Work Ltd. He is an Occupational Medicine Specialist with experience in a wide variety of occupational settings, from heavy industry to public sector organisations in both the UK and New Zealand.

Specialising in complex cases, David provides a comprehensive range of services, including consultancy, file reviews, specialist assessments and rehabilitation management throughout New Zealand.

He is President of the Australasian Faculty of Occupational and Environmental Medicine and was the Faculty Lead for the development of the New Zealand Consensus Statement on the Health Benefits of Work. An authority on issues around medical certification, he presents widely on this topic and provides consultancy on these subjects to many companies.



Ms Suzanne Caragianis

Suzanne Caragianis is an Occupational Therapist specialising in the treatment of hand and upper limb injuries with her own hand therapy practice located in Adelaide.

Suzanne is qualified as a Certified Hand Therapist in the USA and has now recertified on three occasions.

She is a full member of the Australian Hand Therapy Associate and American Hand Therapy Association and is an Adjunct Clinical Lecturer with the University of South Australia.

She has worked in the UK, USA and Switzerland in hand and upper limb trauma and has been running Helping Hands in Bhutan for six years taking therapists and surgeons to undertake volunteer work.

Suzanne has a special interest in nerve compressions in the upper limb.



Dr Peter Connaughton

Peter Connaughton is the President-Elect of Australasian Faculty of Occupational and Environmental Medicine (AFOEM).

Peter works at a private practice in Western Australia mainly consulting to the mining industry. He is also an Adjunct Associate Professor at the University of Notre Dame, Fremantle.

Peter graduated from the School of Medicine - Royal College of Surgeons in Ireland and later studied occupational medicine at the Institute of Occupational Medicine in Edinburgh. Peter is a board member of the charity Child in Need India Australia (CINI) and has a Master of Business Administration from the University of Western Australia.



Deputy President Steven Dolphin

Steven Dolphin was appointed to judicial office as a Deputy President of the South Australian Employment Tribunal and the Workers Compensation Tribunal in December 2014. Prior to his appointment Steven was the Principal of Lieschke and Weatherill Lawyers specialising in employment, industrial and workers compensation law and regularly appearing in state and federal courts, commissions and tribunals.

Steven is also a past chair of the Industrial Relations Committee, and a past member of the Workers Compensation Executive, of the Law Society of South Australia.

Since his appointment he has been very busy with all things necessary for the establishment and operation of the South Australian Employment Tribunal, as well as hearing judicial determinations and appeals in the Workers Compensation Tribunal.



Dr Roberto D'Onise

Roberto D'Onise practices from the Corporate Health Group Specialist Centre and the Corporate Health Group Elizabeth Vale Clinic.

Roberto is contracted by multiple private and public sector organisations to provide services and advice on-site at the client's workplace. He has several years of experience in advising Nyrstar on occupational health matters arising from the operation of one of the country's largest lead smelters.

A Fellow of the Australasian Faculty of Occupational and Environmental Medicine (AFOEM) and holding a Graduate Diploma in Occupational Health and Safety, he specialises in complex medical assessments, permanent impairment assessments, fit for duty assessments, strategic claims management advice, health surveillance and monitoring programs.



Professor Tim Driscoll

Tim Driscoll is an Occupational Epidemiologist and a specialist in occupational and environmental medicine and public health medicine. He is a Professor in epidemiology and occupational medicine at the Sydney School of Public Health and the University of Sydney, Australia, where he runs the general epidemiology teaching and is Director of the Master of Public Health.

Tim's main areas of research interest include the burden of occupational disease and injury; occupational cancer and exposure to occupational carcinogens; increasing the practical application and influence of epidemiological principles and findings; and improving the communication of epidemiological principles and findings to the general public. He is the current chair of the Faculty Education Committee.



Dr Sharyn Gaskin

Sharyn Gaskin has a PhD in environmental health, which focussed on remediation of hydrocarbon-contaminated soil at a mine site (with Rio Tinto).

Her postdoctoral career began with the Australian Antarctic Division and included four months in sub-Antarctic Macquarie Island as part of a field research team involved in a hydrocarbon risk and remediation program for the heritage island. Thereafter she has been a Research Fellow with the Occupational and Environmental Health group at Adelaide University.

Sharyn's research areas are primarily focussed on occupational and environmental exposure science including industry-wide studies in healthcare, pest control, manufacturing, emergency services and mining industries.



Dr David Goddard

David Goddard has worked in occupational medicine for 42 years as a medical officer in industry, as a medical inspector of workplaces, and as medical adviser to the Victorian State Workers' Compensation scheme. Since 1990 he has taught occupational medicine to medical students and toxicology and occupational hygiene to post-graduate students at Monash University, Victoria.

For six years he worked part time in educational development with The Australasian Faculty of Occupational and Environmental Medicine (AFOEM), compiling the training curriculum, introducing formative assessment, and working with the Assessment Committee to expand and improve assessment. In 2013 he received the President's Award for outstanding contribution to the Faculty in education, training and assessment.



Dr Erich Heinzle

Erich Heinzle graduated from Adelaide University in 2000 and has spent the majority of his time since in industrial medicine practice.

Erich recently completed a Master of Public Health and is undertaking further study in mathematics and statistics.

Erich lives in the Adelaide Hills with his family and currently enjoys a mix of rural general practice with its after hours on call component, as well as work at General Motors Holden in their on-site clinic.

Erich is particularly interested in the mathematical underpinnings of Bayesian inference, information theory, principal agent theory and the workings of insurance systems commonly encountered in medical practice.

Dr Geoffrey Graham

Geoffrey Graham was awarded Fellowship of the Australasian College of Occupational Medicine in 1986. For a number of years he combined his practice in occupational medicine with sports medicine. During this time he was Senior Medical Officer at a league football club, Medical Officer for the SA state football team on two occasions and Medical Officer for the Australian Senior Rowing Team which included the Awesome Foursome, whilst they trained and competed in Switzerland and Germany.

He was until recently a Designated Aviation Medical Examiner with Civil Aviation Safety Authority Australia and with Hong Kong Civil Aviation Department.

He is currently in private practice as an occupational physician and is an accredited permanent impairment assessor with ReturnToWorkSA and WorkCover WA.



Mr Ganyk Jankewicz

Ganyk Jankewicz has worked in the field of occupational health for 35 years, with 16 years as a scientific officer in the Occupational Health Division at the South Australian Health Commission and South Australian Department of Labour. Ganyk spent seven years as a consultant in the private sector as a Senior Occupational Hygienist and 11 years with Occupational Health and Safety Consultants at the University of Adelaide.

Working in the Occupational Health Division within the South Australian Health Commission, together with occupational physicians, Ganyk has worked in many areas of occupational hygiene, providing consultancy to the South Australian Government, industry, employers, unions and workers, predominantly in the area of hazardous substances, indoor air quality, noise, heat stress and ventilation.



Dr John Meegan

John Meegan is an Occupational Physician in private practice for over twenty years. He was, in a past life, the Director of Occupational Health Unit and visiting Occupational Physician in the care of the staff at Repatriation General Hospital and also a Peer Review Advisor and Medical Advisor to WorkCoverSA. He has in addition to his Occupational Medicine Fellowship and Diploma of Occupational Health, qualifications in public health, musculoskeletal medicine and hypnosis and having previously spent time as a psychiatry trainee.



Ms Helen Moody

Helen Moody is a consultant Occupational Therapist and Certified Professional Ergonomist with Corporate Health Group in Adelaide. With a background in hand injuries, burns, rheumatology and orthopaedic rehabilitation Helen has applied this medical knowledge to posture and movement as it relates to ergonomics.

Helen works across a wide range of industries undertaking job analysis for injury prevention and return to work purposes, project work with various companies to solve problems associated with musculoskeletal risk factors and delivers training programs focusing on posture training relevant to specific job roles.

One of her special areas of interest is in Participatory Ergonomics where there is collaborative development of ergonomic interventions including design ideas but also in seeking solutions for individuals returning to work with complex needs.



Dr Josh Munn

Josh Munn is from country South Australia and trained at Adelaide University before joining the Army as a uniformed Medical Officer.

He completed General Practice training in 2005 and worked in a high occupational medicine load General Practice in Townsville, dealing mainly with mining, refining, transport and manufacturing.

Josh started a Masters in Occupational Medicine, initially with no intention of leaving General Practice but got swept up in the excitement and started Australasian Faculty of Occupational and Environmental Medicine (AFOEM) training in 2009, gaining Fellowship in 2013.

He is currently working in treating doctor and independent medical assessment/permanent impairment roles in Adelaide.



Dr Dino Pisaniello

Dino Pisaniello is a Professor of Occupational and Environmental Hygiene at the University of Adelaide in South Australia.

Dino is a certified occupational hygienist and a chartered generalist occupational health and safety professional and holds Fellowships of the Australian Institute of Occupational Hygienists, the Safety Institute of Australia and the Royal Australian Chemical Institute. Dino is a Past Chairman of the International Commission on Occupational Health Scientific Committee on Work and Vision.

Dino is also Past President of the Australian and New Zealand Association of OHS Educators, the Australian Institute of Occupational Hygienists and, from 2001 to 2005, was the Chairman of the Congress of Occupational Safety and Health Association Presidents.



Dr Kevin Sleight

Kevin Sleight is an Occupational and Environmental Physician with current appointments as Clinical Lead Medical at WorkSafe Victoria and the Transport Accident Commission. Kevin is also a Consultant at Sonic Health Plus Specialist Group, Equisuper and Solar Turbines Australia. Kevin also acts as a Medical Review Officer for a number of companies and Australian Government departments.

After 20 years' experience in General Practice, Kevin specialised in occupational medicine and has consulted solely as an Occupational Physician for over 18 years.

Previous appointments include Medical Director of Caterpillar Asia Pacific, Occupational Physician at Ansett Australia and Ansett Air New Zealand Engineering Services, Medical Adviser to Note Printing Australia and to the Herald and Weekly Times Media Group.



Dr Dion Suyapto

Dion Suyapto is a Consultant Occupational Physician at the Corporate Health Group in Adelaide. He sees patients for injury management, fitness for work and medico-legal assessment and reporting.

Dion completed his medical degree from the University of Adelaide in 2003 and Graduate Diploma of Occupational Health and Safety Management in 2013. He obtained his Fellowship of the Australasian Faculty of Occupational and Environmental Medicine (RACP) in 2014.



Ms Margaret Thompson

Margaret Thompson completed her post-graduate studies at the University of London, Medical School of Laryngology, Rhinology and Otology, Margaret then moved to Australia where she worked for a short period of time within the then National Acoustic Laboratory, now known as Australian Hearing. She subsequently moved to Adelaide to take up the position of Manager, Audiological Services with Corporate Health Group.

Corporate Health Group undertakes pre-employment audiometry assessments, noise surveys, hearing conservation programs, noise trauma counselling and various other audiological duties, including noise surveys.

Margaret has wide ranging experience in provision of these services to the defence, research and mining industries, in addition to local government, state transport and police. She also provides ongoing support and mentoring to staff and medical professions within Corporate Health Group and her peer groups.



Mr Len Turczynowicz

Len Turczynowicz has worked in the field of public health, toxicology and human health risk assessment for over 29 years, with 20 years in the South Australian Department of Health and the balance in the environmental consulting industry.

Previously Len undertook chemical and microbiological analyses in government food and air quality laboratories following a period of studies in pharmacy.

Len has worked across a diverse range of public health areas including asthma and risk factors; site contamination including development of national health-based investigation levels; assessment and mitigation of environmental and occupational exposures associated with industrial facilities, processes and mining operations; and toxicological assessments for policy development and regulatory review.

ABSTRACTS

PERSONAL PROTECTION EQUIPMENT WORKSHOP

Macedo L, Kennedy G

The Personal Protection Equipment Workshop will consist of a practical short training where the attendees will have a chance to familiarise themselves with a wide range of respirators, hearing protectors, protective clothing and eyewear.

NOISE AND HEARING WORKSHOP

Thompson M

Ms Margaret Thompson will discuss current Environment Protection Act regulations and testings. Attendees will have the opportunity to review common audiograms and understanding the Xs and Os when interpreting an audiogram.

RESEARCH PROJECT

Driscoll T

The research project is one of the summative assessments for Australasian Faculty of Occupational and Environmental Medicine (AFOEM) trainees. This session will consider all aspects of the research project, including development of the topic, finding a project supervisor, ethics, conducting the project, the report, the report review process, how to respond to requests for modifications to the report, and development and submission of the Ramazzini Prize abstract. The format will be a mixture of presentation, discussion and answering trainees' questions.

ENVIRONMENTAL MEDICINE: CASE STUDIES AND PANEL Q&A

Gaskin S, Turczynowicz L, Pisaniello D

Using a case study approach, the session will address chemicals in the environment, in particular pesticides and soil contaminants. The Environmental Health Risk Assessment framework will be discussed, and linked in with concepts outlined in the Australasian Faculty of Occupational and Environmental Medicine (AFOEM) Training Manual (Environmental Medicine). Participants will have the opportunity to discuss particular issues in practice.

COMPLEX INJURY MANAGEMENT

Caragianis S, Moody H, Bottroff N

In this joint presentation, Suzanne Caragiannis, Hand Therapist, Helen Moody, Ergonomist and Natalie Bottroff, Return to Work Consultant, will discuss different aspects of management in a complex injury scenario. It will involve a case study style presentation of a council worker who has been employed for the past 16 years as part of a horticultural team and who has multiple upper limb pathology.

Suzanne will present the overview of the case including diagnosis, background to injury, assessment and treatment methods from the therapists perspective and outline the barriers to return to work.

Helen will focus on assessment of the physical job demands and how to match these with the client's physical function while still accommodating the practical needs from the perspective of the workplace.

Natalie will explore psychosocial aspects of return to work and how this dovetails with the other aspects of medical care, treatment and the eventual goal of returning to work, where there are complex factors melding together to provide significant barriers to return to work.

At the end of the presentation there will be time allocated for a group discussion regarding the presenting problems and opportunity for questions.

REFERENCES AND PRE-SESSION READING

All Trainees

National Standard for Health Assessment of Rail Safety Workers

Refer to the following website link:

www.ntc.gov.au

Unions

Familiarise yourself with the union process, how to become a member and how to become a union representative, their roles and responsibility, their involvement in different organisation, what they can do and what they cannot do.

Refer to the following website links:

www.fairwork.gov.au

www.fairwork.gov.au/how-we-will-help

www.fairwork.gov.au/website-information

Stage A Trainees

Stage A Guidance linked [here](#).

NOTES

[illegible]

NOTES

This image shows a blank sheet of handwriting practice paper. It features two vertical columns of horizontal lines. Each column contains 18 lines, all of which are dashed. The lines are evenly spaced and extend across the width of their respective columns, providing a guide for letter formation and alignment. There is no text or other markings on the page.